



**Geophysical Survey of
Russian Academy of Sciences**

**The Trofimuk Institute of Petroleum Geology and Geophysics, Siberian
Branch of the Russian Academy of Sciences**

**Siberian Research Institute of Geology,
Geophysics and Mineral Resources**



XV INTERNATIONAL SEISMOLOGICAL WORKSHOP

**“Modern methods of processing
and interpretation of seismological data”**

First circular

**September 7–11, 2020
Novosibirsk, Russia**



Seismological workshop topics

- The current state of seismic observations in various regions of the Russian Federation and neighboring countries.
- New seismological data processing and interpretation programs.
- Geodynamics, seismotectonics and their relationship with seismicity.
- Seismological Observations in Northern Eurasia.
- Induced seismicity.

Preliminary Workshop Program

September 6 – arrival of participants.

September 7–9 – plenary sessions with reports by leading Russian and foreign scientists.

September 10 – thematic sessions.

September 11 – technical tour.

September 12 – departure day.

Material Requirements

Conference materials required from participants should include abstracts and articles. Abstracts of the XV International Seismological Workshop will be published by the beginning of the conference. Reviewed articles will be published in the Russian Journal of Seismology within the year after it.

Abstracts are submitted in electronic form. The abstract size must be not exceeding one page. Drawings are not accepted. Abstracts must be typed in a Microsoft Word text editor (file format * .doc, * .docx) in Times New Roman font, not bold, 12 pt in size, with one line of vertical spacing, on A4 sheet format with portrait orientation and 25 mm left, right, top and bottom margins. Bibliographic references are to be given as numbers in square brackets.

The list of authors should include: full and abbreviated name of the organization, city, country, scientific title and job position, e-mail.

The list of requirements for the technical design of materials is published on the website of GS RAS <http://www.gsras.ru/new/conf/>. Materials are accepted in Russian or English.

Russian authors provide both materials and expert conclusion on the possibility of their open publication.

The organizing committee will publish no more than two abstracts from one participant; only one oral report is allowed. Presentation for the oral report is to be in Power Point format in English.

Regulations: for plenary reports – 30 minutes, for other reports – 15 minutes.

The organizing committee reserves the right to select oral reports and materials for publication.

Working languages

Russian and English.

Visas and documents

Citizens of the CIS countries need only international passports to visit the Russian Federation, no visa is required. Citizens of the EC countries and the United States should have Russian visa.

Registration

Applications for participation in the Workshop and abstracts should be sent to the secretary of the organizing committee by e-mail isw@gsras.ru The registration form is attached.

The deadline for applying for participation in the conference – February 28, 2020.

The deadline for submission of abstracts – May 29, 2020.

Deadline for submitting articles – June 8, 2020.

Articles should be sent to e-mail rgs@gsras.ru

Registration fee

Registration fee payment only by bank transfer is accepted until August 1, 2020. The registration fee is 2500.00 rubles, including VAT (20%) – 416.67 rubles.

Accommodation, travel and meals are paid by the participants themselves.

Organizational Committee Addresses

GS RAS: Russia, 249035,
Obninsk, Kaluga rgn., Lenin Avenue., 189
Ph.: +7-495-912-68-72; Fax: +7-484-393-02-34

**Seismological, Altai-Sayan branches
of GS RAS:** Russia, 630090,
Novosibirsk, Academician Koptyuga Avenue, 3,
Ph. +7-383-333-20-21, Fax: +7-383-333-32-28

Secretaries of the organizing committee

Milekhina Alexandra Mikhailovna
Russia, Obninsk
Ph.: +7-484-393-22-05; +7-495-912-68-72
E-mail: isw@gsras.ru

Turova Anna Valerievna
Russia, Novosibirsk
Ph.: +7-913-905-05-62
E-mail: anna@gs.nsc.ru

Dear colleagues!

We invite you to take part in the XV International Seismological Workshop “Modern Methods of Processing and Interpretation of Seismological Data”. The event will be held in Novosibirsk, Academic campus.

Novosibirsk is the third largest city in Russia. It is the largest trade, business, cultural, transport, educational and scientific center of Siberia. Often Novosibirsk is unofficially called the “Capital of Siberia”

Novosibirsk was founded in 1893, the population is 1,618,039 people (2019), due to which it is the most populated city in the Asian part of Russia.

The city is located on the banks of the Ob River near the Novosibirsk reservoir, formed by the dam of the Novosibirsk hydro power plant. The large reservoir is also named as "Ob Sea". The main purpose of the water reservoir is to provide the city with electricity, and its banks are a popular recreation area for the citizens.

Academic campus is scientific visit card of the Siberian capital, it is located in the immediate vicinity of the Ob Sea. Since 1959, dozens of scientific institutes have settled here together with Novosibirsk State University. Some of them carry out research in seismology. During the conference, participants will be able to get acquainted with the advanced developments of local seismological scientists, as well as visit the vibroseismic test site in the village of Bystrovka, where unique models of vibration sources are collected. They allow to carry out studies with seismic deep sounding of the earth's crust and upper mantle and monitor the stress-strain changes in the rock mass on huge territories.



View of the center of Novosibirsk from the Ob river



The building of the Opera and Ballet Theater

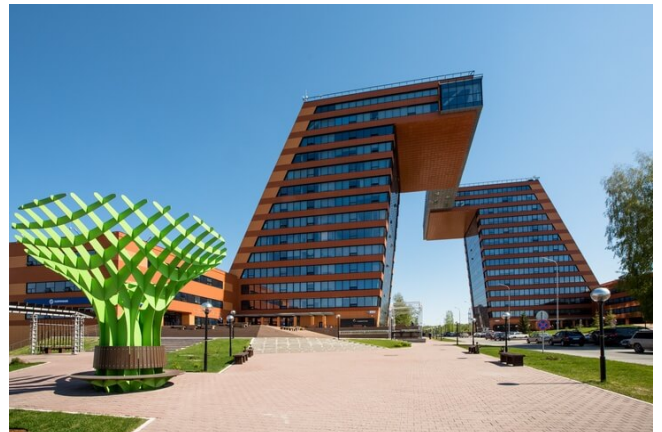

Technopark of Academic campus



Registration form
of participant of XV International
Seismological Workshop
“Modern methods of processing
and interpretation of seismological data”
Novosibirsk, Russia
September 7–11, 2020

Full Name _____

Academic degree, title, position _____

Affiliation _____

Address for correspondence (including zip code) _____

Phone _____

E-mail _____

The authors _____

Report title _____

Please indicate the participation form:

- oral report;
- poster presentation;
- listener.

Signature

Date